

Description

The GLV44/45 is a globe valve, with a simple bolted bonnet, rising stem/handwheel and screwed connections. Manufactured as standard in NiAlBr giving long service life on seawater applications. In conformance with the Pressure Equipment Directive 97/23/EC.

Standard Range,
GLV44 with integral seat,
Sizes: 1/2" to 2"
Connections: Screwed.

GLV45 with renewable seat,
Sizes: 1/2" to 2"
Connections: Screwed.

Pressure class 150# & 300#



Materials

Regularly manufactured in a full range of materials including:

- Nickel Aluminium Bronze – ASTM B148
- Nickel Aluminium Bronze - DS02 747 Part 3
- Gunmetal – DS02 830 Part 1
- Bronze – ASTM B61/B62
- Brass – HTB1
- Titanium – ASTM B367
- Hastelloy®
- Monel®

Other materials available on request

Features

- Bolted Bonnet
- Rising stem & handwheel
- Swivel disc
- Multiple ring stem packing
- Back seat facility

Options

- Integral or renewable seats
- Screw down non-return
- Contoured plug
- Needle plug
- Locking facility
- Alternative threads, NPT, BSPP, BSPT

Specifications

- ANSI B16.34 Wall Thickness
- ANSI B1-20.1 Screwed Ends
- PED Conformity

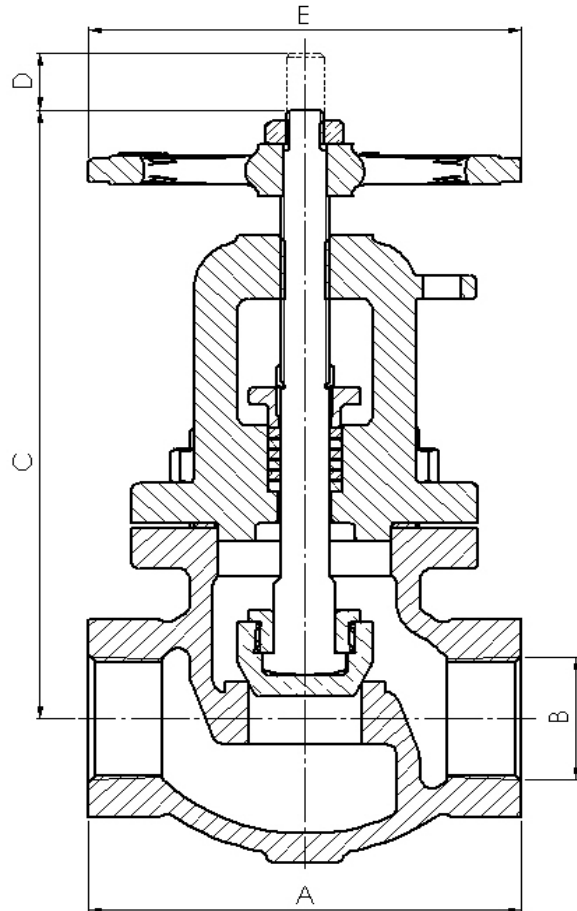

Dimensions

Screwed NPT

VALVE SIZE		mm unless stated					WEIGHT kg	
INCH	mm	A	B Thread	C	D	E	CLASS 150	CLASS 300
1/2"	15	83	1/2" NPT	130	9	102	1.5	1.8
3/4"	20	95	3/4" NPT	148	10	102	2.1	2.5
1"	25	111	1" NPT	168	16	102	3.4	4
1 1/2"	40	152	1 1/2" NPT	199	19	127	6	7
2"	50	178	2" NPT	221	22	178	11	13

Pressure Class 150# & 300#

GLV44:
shown with integral seats

GLV45:
has renewable seats

