

Fullbore Non-Return/ Stop Valves

SCREWED CONNECTIONS

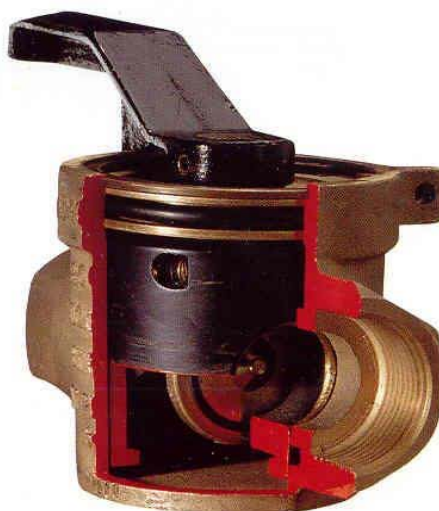

Manufactured to extremely high standards in the highest quality materials. These valves operate as normal stop valves when the handle is turned 90° from flow position.

There is a hinged flap incorporated in the plug which acts as a swing check non-return when the plug is turned to the flow position.

Any repair or replacement can be carried out without interference to the pipe system.

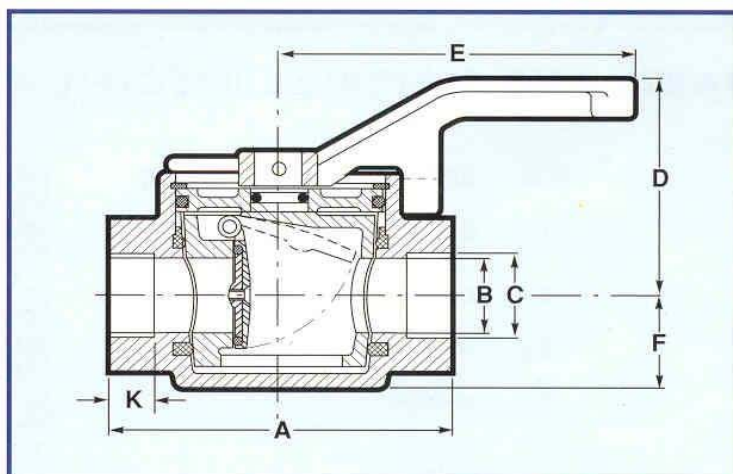

SPECIFICATION

SIZES

20mm - 32mm (1" - 1-1/2") nominal bore

BODIES

Cast from gunmetal or aluminium bronze.

ENDS

Screwed NPT or BSP

PLUGS

Cast from gunmetal or aluminium bronze, both surface coated.

SEALS

Sealing of both non-return and stop is by synthetic rubber seals

LOCKING FACILITIES

Valves can be locked open and closed, if required

QUALITY ASSURANCE

Our own exacting quality control system is fully supported by ISO 9001 accreditation and we are audited at regular intervals by Lloyds register.

DIMENSIONS

Dimensions in millimetres unless shown otherwise

Nom. Size	A	B	C BSP	D	E	F	K	Wt. Kg.
20	116	22	1"	83	115	32	16	2.5
25	130	27	1-1/4"	87	130	35	18	3.5
32	150	35	1-1/2"	100	150	43	20	5.75

- Test Pressure 20 bar
- Max. Working Pressure 10 bar
- Max. Working Temp. 104°C

Sackville Street, Skipton,
North Yorkshire, BD23 2PS England

Telephone: +44 (0) 1756 792346 Fax: +44 (0) 1756 792347 E-mail: sales@brooksbank.co.uk
www.brooksbank.co.uk

Fullbore Non-Return / Stop Valves