

SINGLE PIECE Ball Valves

The product of over 50 years experience in the industrial valve market, these reduced bore single piece ball valves incorporate all the features and benefits the end user expects to provide a proven & reliable solution to a range of applications.

Features include:

- Anti static, anti blowout stem
- Cavity pressure relieving seats
- Pressure equalising ball design
- Solid ball
- Screwed in insert
- ISO 5211 mounting platform
- Removal of lever for actuation does not compromise seal integrity
- Chevron packing on sizes 3" and above

Manufactured from a full range of materials including:

- Aluminium Bronze - European & American Specifications
- Gunmetal - European & American Specifications
- Duplex
- Super Duplex
- Titanium
- Hastelloy®
- Monel
- 254 SMO
- Other materials available on request

Manufacturing Standards

- Designed generally in accordance with API 6D & EN 17292 (Formerly BS5351)
- Wall thickness in accordance with ANSI B16.34
- Face to face dimensions in accordance with ANSI B16.10
- Flange dimensions in accordance with ANSI B16.5
- Bronze material in accordance with ANSI B16.24

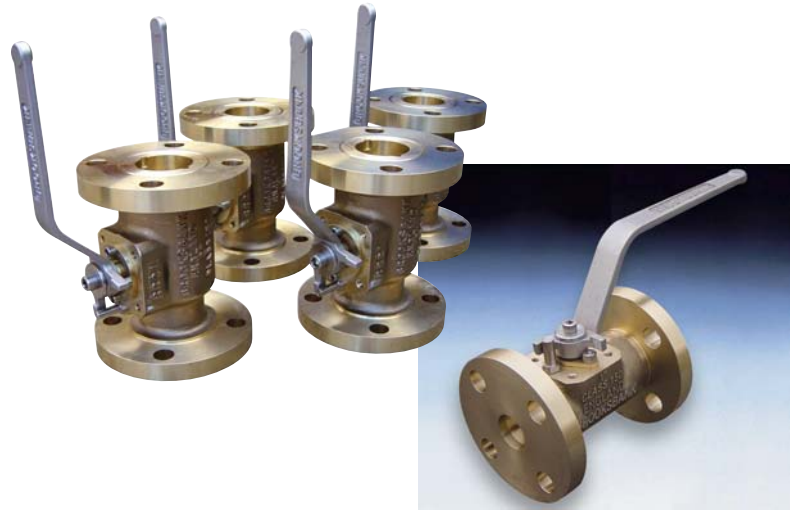

DIMN	CLASS	A	B	C	D	E	F	Wt Kg
3/4"	150	3/4"	1/2"	3 7/8"	4 5/8"	8"	4 3/16"	2.5
3/4"	300	3/4"	1/2"	4 5/8"	6"	8"	4 3/16"	
1"	150	1"	3/4"	4 1/4"	5"	8"	4 9/32"	3.5
1"	300	1"	3/4"	4 7/8"	6 1/2"	8"	4 9/32"	
1 1/2"	150	1 1/2"	1"	5"	6 1/2"	8"	4 17/32"	5.5
1 1/2"	300	1 1/2"	1"	6 1/8"	7 1/2"	8"	4 17/32"	
2"	150	2"	1 1/2"	6"	7"	8"	4 7/8"	9
2"	300	2"	1 1/2"	6 1/2"	8 1/2"	8"	4 7/8"	
3"	150	3"	2"	7 1/2"	8"	12"	5 3/4"	18
3"	300	3"	2"	8 1/4"	11 1/8"	12"	5 3/4"	
4"	150	4"	3"	9"	9"	12"	6 13/32"	28
4"	300	4"	3"	10"	12"	18"	8 29/32"	
6"	150	6"	4"	11"	10 1/2"	24"	9 21/32"	47
6"	300	6"	4"	12 1/2"	15 7/8"		G/BOX	
8"	150	8"	5 3/4"	13 1/2"	11 1/2"		G/BOX	92
8"	300	8"	5 3/4"	15"	16 1/2"		G/BOX	
10"	150	10"	7 3/8"	16"	13"		G/BOX	130
10"	300	10"	7 3/8"	17 1/2"	18"		G/BOX	

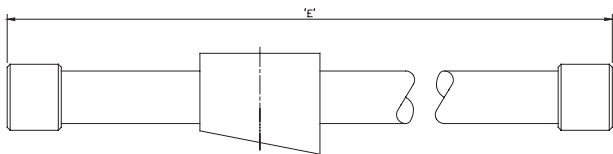

6" ONLY

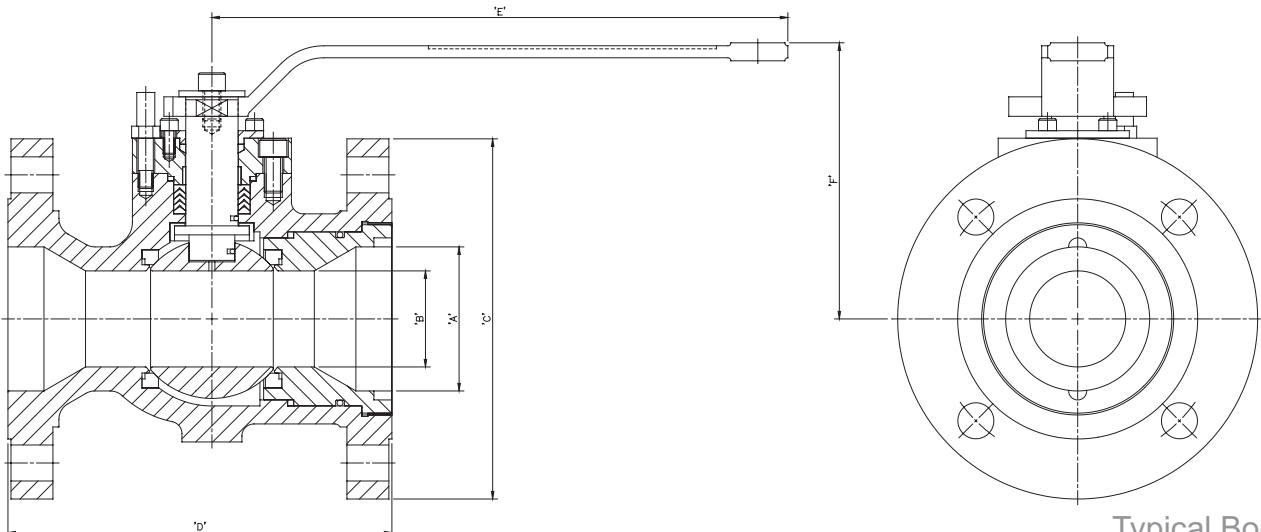

Typical Body Details