

Description

The GLV42 is a globe valve, with a union bonnet, integral seat, rising stem/handwheel and screwed connections. Manufactured as standard in NiAlBr giving long service life on seawater applications.

In conformance with the Pressure Equipment Directive 2014/68/EU.

Standard Range,
Sizes: 1/2" to 2"
Connections: Screwed.

Pressure class: 150/300#



Materials

Regularly manufactured in a full range of materials including:

Nickel Aluminium Bronze – ASTM B148
Nickel Aluminium Bronze - ASTM B148
Gunmetal – DS02 830 Part 1
Bronze – ASTM B61/B62
Brass – HTB1
Titanium – ASTM B367
Hastelloy®
Monel®

Other materials available on request

Features

Union Bonnet
Rising stem & handwheel
Swivel disc
Multiple ring stem packing
Back seat facility
Integral seats

Options

Monel trim
Alternative connections: NPT, BSPP, BSPT,
Socket Weld, Capillary Brazed.

Specifications

ASME B1.20.1 End Connections
Overall length - manufacturers standard
PED Conformity
Designed generally to: MSS-SP-80

Series: GLV42
Union Bonnet Globe Valve

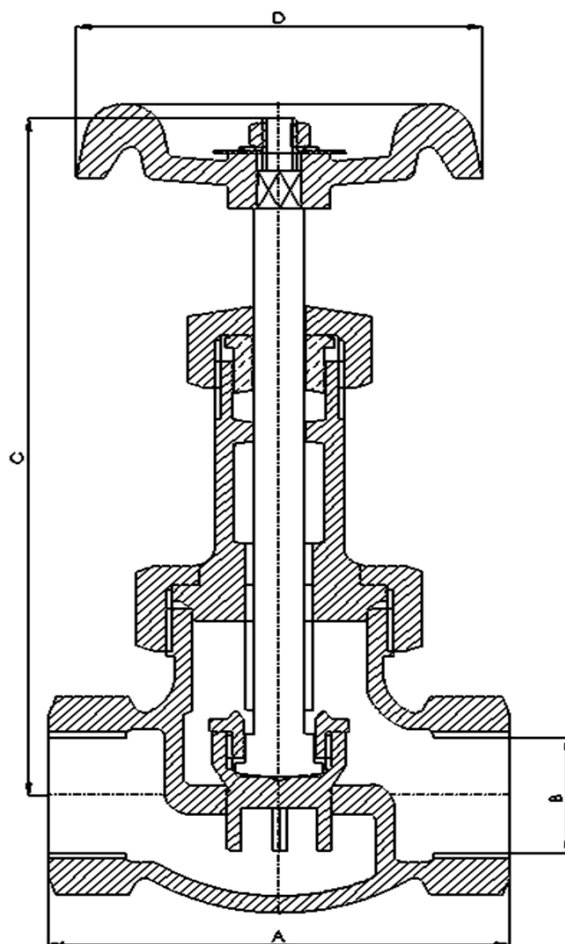

Dimensions

Screwed NPT

VALVE SIZE		mm				WEIGHT
INCH	mm	A	B Thread	C	D	kg
1/2"	15	68	1/2" NPT	133	67	0.9
3/4"	20	84	3/4" NPT	157	73	1.2
1"	25	92	1" NPT	170	85	1.7
1 1/4"	32	105	1 1/2" NPT	172	100	2.6
1 1/2"	40	118	1 1/2" NPT	200	100	2.5
2"	50	145	2" NPT	237	132	5.5

Pressure class: 150/300#
MWP = 362psi (25bar) at -10 to 66degC