

Series: BAV17-2 3 Piece Trunnion Mounted Ball Valve

Description

The BAV17-2 is a 3 piece side entry, full bore trunnion mounted ball valve, with integral cast flanges. Manufactured as standard in NiAlBr giving long service life on seawater applications.

In conformance with the Pressure Equipment Directive 2014/68/EU.

Standard Range,
Sizes: 14" to 24"
Connections: ANSI 150 & 300.



Materials

Regularly manufactured in a full range of materials including:

Nickel Aluminium Bronze – ASTM B148
Nickel Aluminium Bronze - DS02 747 Part 3
Gunmetal – DS02 830 Part 1
Bronze – ASTM B61/B62
Brass – HTB1
Titanium – ASTM B367
Hastelloy®
Monel®

Other materials available on request

Features

Anti-static / Anti blowout stem
Cavity pressure relieving seats
Pressure equalising ball design
ISO 5211 mounting platform
Bolted Bonnet
Bi-directional Flow
Spring loaded seat

Options

Bare shaft (for actuation by others)
Actuation to customer specifications
Locking facility (open & closed)
Extended stems (insulation allowance)

Specifications

ASME B16.5 Flange Dimensions
ASME B16.10 Face to Face Length
ASME B16.34 Wall Thickness
PED Conformity
Designed generally in accordance with: API 6D
& ISO 17292 (formerly BS5351)

Series: BAV17-2
3 Piece Trunnion Mounted Ball Valve

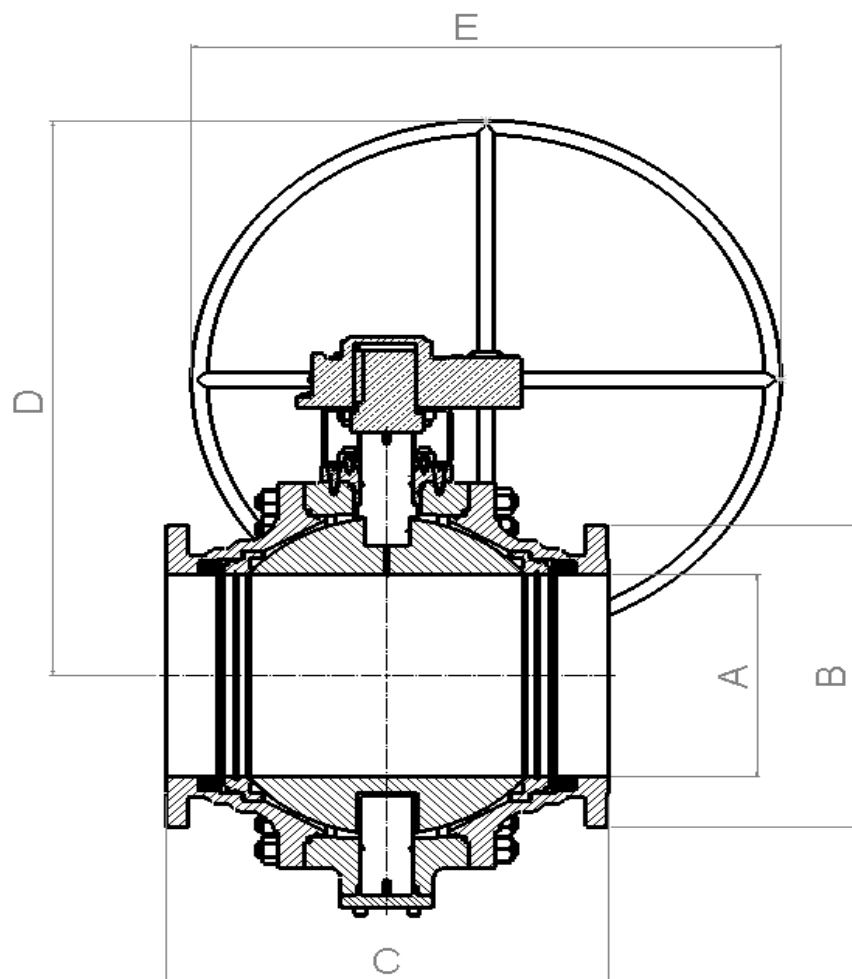

Dimensions

ANSI 150

VALVE SIZE		mm						WEIGHT kg
INCH	mm	A NB Ball	B	C	D	E LEVER HANDWHEEL		
14"	350	356	533	686	979	G/BOX	914	874
16"	400	406	597	762	1142	G/BOX	914	1311
18"	450	457	635	864	937	G/BOX	610	1554
20"	500	508	699	914	1115	G/BOX	762	2049
24"	600	610	813	1067	1326	G/BOX	762	3599

Series: BAV17-2
3 Piece Trunnion Mounted Ball Valve

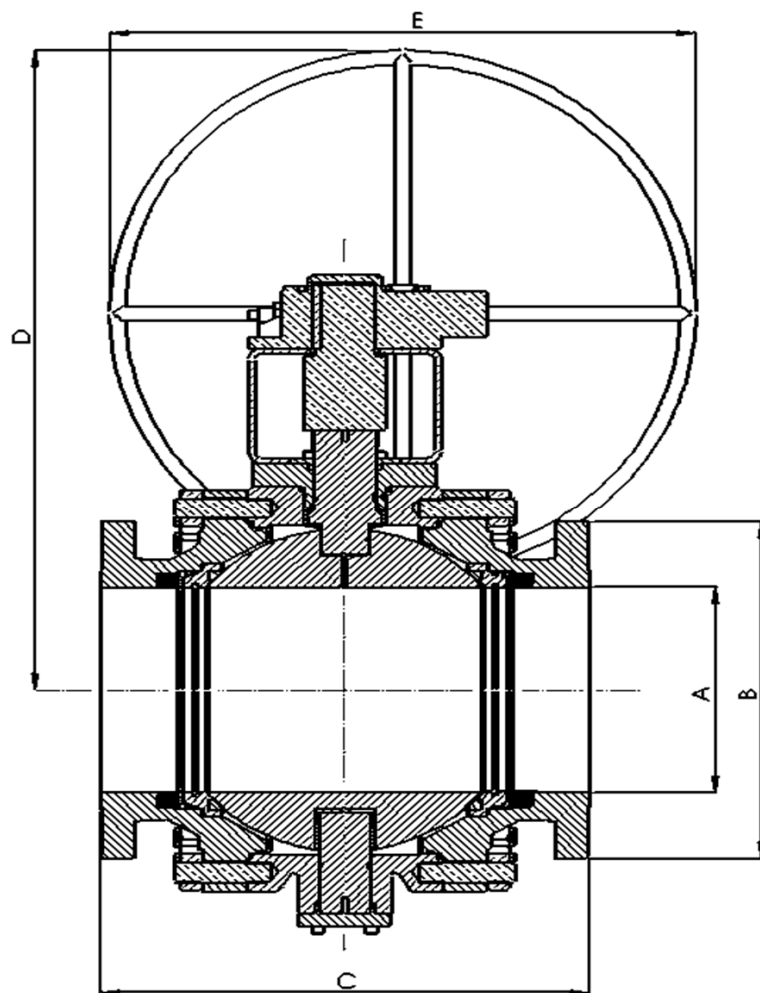

Dimensions

ANSI 300

VALVE SIZE		mm						WEIGHT
INCH	mm	A NB Ball	B	C	D	E LEVER HANDWHEEL		kg
14"	350	356	584	762	1112	G/BOX 914		1211
16"	400	406	648	838	916	G/BOX 600		1829
18"	450	457	711	914	1117	G/BOX 800		2248
20"	500	508	775	991	1373	G/BOX 914		3720