

Description

The GLV46/47 is a globe valve, with a union bonnet, rising stem/handwheel and integral cast flanges. Manufactured as standard in NiAlBr giving long service life on seawater applications.
In conformance with the Pressure Equipment Directive 2014/68/EU.

Standard Range,
GLV46 with integral seat,
Sizes: 1/2" to 2"
Connections: ANSI 150.

GLV47 with renewable seat,
Sizes: 1/2" to 2"
Connections: ANSI 150.

Features

Union Bonnet
Rising stem & handwheel
Swivel disc
Multiple ring stem packing
Back seat facility

Options

Integral or renewable seats
Screw down non-return
Contoured plug
Needle plug

Materials

Regularly manufactured in a full range of materials including:

Nickel Aluminium Bronze – ASTM B148
Nickel Aluminium Bronze - DS02 747 Part 3
Gunmetal – DS02 830 Part 1
Bronze – ASTM B61/B62
Brass – HTB1
Titanium – ASTM B367
Hastelloy®
Monel®

Other materials available on request



Specifications

ASME B16.5 Flange Dimensions
ASME B16.10 Face to Face Length
ASME B16.34 Wall Thickness PED
Conformity

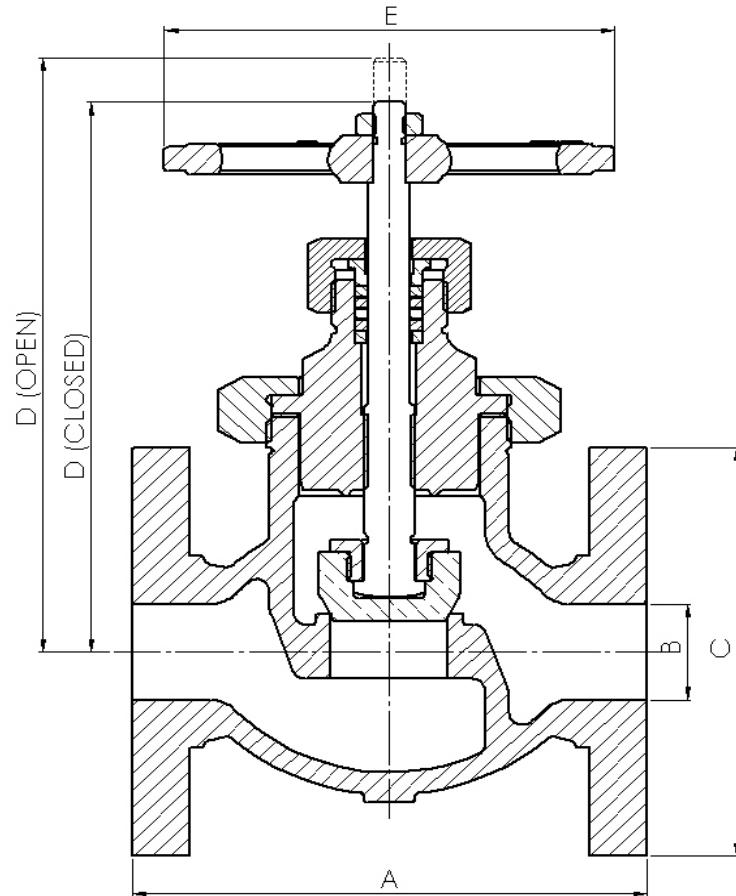

Dimensions

ANSI 150

VALVE SIZE		mm						WEIGHT
INCH	mm	A	B NB Pipe	C	D CLOSED	D OPEN	E	kg
1/2"	15	108	13	89	109	118	102	2
3/4"	20	117	19	98	119	128	102	2.8
1"	25	127	25	108	145	157	102	4.6
1 1/2"	40	165	38	127	180	200	127	7.9
2"	50	203	51	152	239	266	178	16

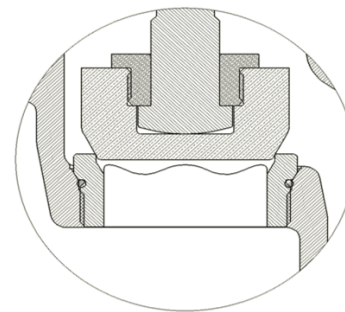

GLV46:
shown with integral seats

GLV47:
has renewable seats