

Series: GAV22-23
Bolted Bonnet Wedge Gate Valve

Description

The GAV22/23 is a wedge gate valve, with a bolted bonnet, rising stem & handwheel, solid wedge and integral cast flanges. Manufactured as standard in NiAlBr giving long service life on seawater applications. In conformance with the Pressure Equipment Directive 2014/68/EU.

Standard Range,
GAV22 with integral seats,
Sizes: 1/2" to 4"
Connections: ANSI 150 & 300.

GAV23 with renewable seats,
Sizes: 2" to 4"
Connections: ANSI 150 & 300.



Materials

Regularly manufactured in a full range of materials including:

Nickel Aluminium Bronze – ASTM B148
Nickel Aluminium Bronze - DS02 747 Part 3
Gunmetal – DS02 830 Part 1
Bronze – ASTM B61/B62
Brass – HTB1
Titanium – ASTM B367
Hastelloy®
Monel®

Other materials available on request

Features

Bolted Bonnet
Outside screw & yoke
Rising stem & handwheel
Solid wedge
Multiple ring stem packing
Back seat facility

Options

Integral or renewable seats
Locking facility
Flexible wedge (4" only)

Specifications

ASME B16.5 Flange Dimensions
ASME B16.10 Face to Face Length
ASME B16.34 Wall Thickness
PED Conformity
Designed generally in accordance with: BSEN 12288 Series A (formerly BS5154)

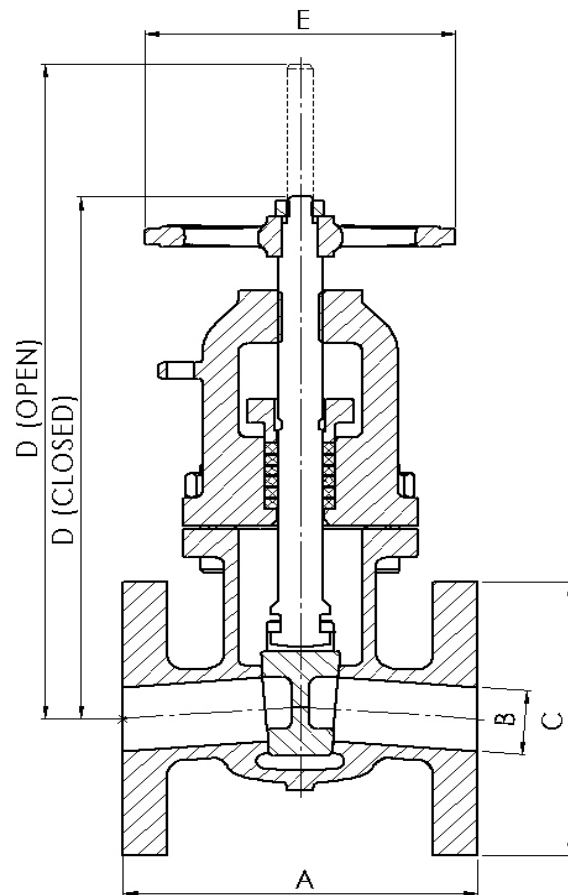

Dimensions

ANSI 150

VALVE SIZE		mm						WEIGHT
INCH	mm	A	B NB Pipe	C	D CLOSED	D OPEN	E	kg
1/2"	15	108	13	89	149	169	102	3
3/4"	20	117	20	98	165	188	102	4
1"	25	127	25	108	206	238	102	5
1 1/2"	40	165	40	127	252	296	127	9
2"	50	178	51	152	312	366	178	14
2 1/2"	65	191	64	178	423	488	254	25
3"	80	203	76	191	423	506	254	26
4"	100	229	102	229	506	645	305	42

GAV22:
shown with integral seats

GAV23:
has renewable seats
(Only 2" and above)

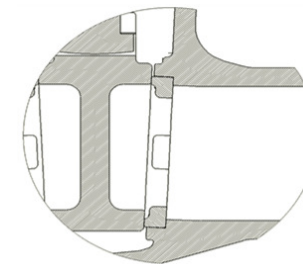

Series: GAV22-23
Bolted Bonnet Wedge Gate Valve

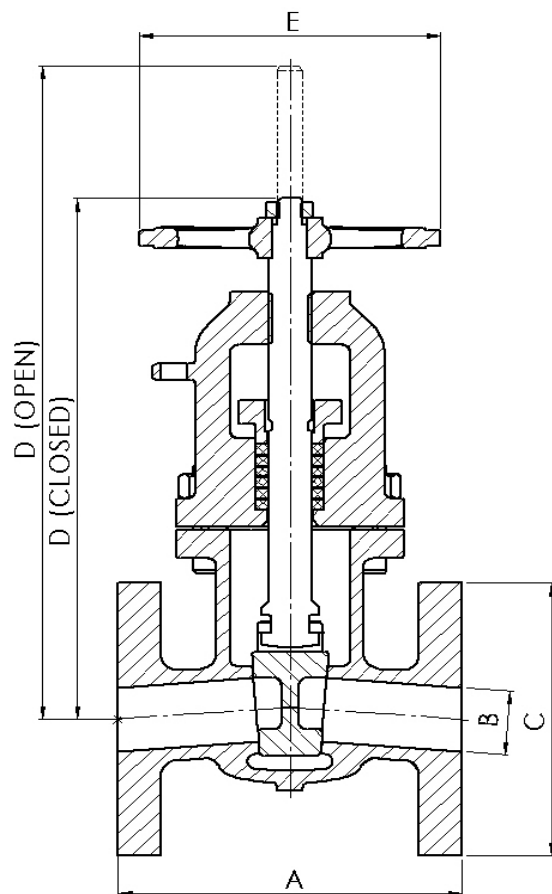

Dimensions

ANSI 300

VALVE SIZE		mm						WEIGHT
INCH	mm	A	B NB Pipe	C	D CLOSED	D OPEN	E	kg
1/2"	15	140	15	89	145	165	102	3
3/4"	20	152	20	98	161	184	102	4
1"	25	165	25	124	203	256	102	7
1 1/2"	40	190	40	127	245	289	127	12
2"	50	216	51	165	312	362	178	19
3"	80	282	76	209	423	506	254	36
4"	100	305	102	229	508	611	305	52

GAV22:
shown with integral seats

GAV23:
has renewable seats
(Only 2" and above)

